



Fraserway RV

Your Vehicle to Adventure™

RV Type:

SCOUT OLYMPIC



Instruction Manual

ENGLISH



CANADIAN TRAFFIC RULES AND ROAD SIGNS	4
TRAFFIC RULES	4
ROAD SIGNS	6
CABIN	7
IGNITION.....	7
AUTOMATIC TRANSMISSION	7
TOW/HAUL	7
CRUISE CONTROL.....	7
PARKING BRAKE.....	8
LIGHTS.....	8
DRIVE MODES	8
INSTRUMENT CLUSTER OVERVIEW	8
VEHICLE CARE AND MAINTENANCE	9
GASOLINE	9
ENGINE OIL	9
TIRES	9
VEHICLE SPECIFICATIONS	10
EXTERNAL VIEW.....	11
AWNING	12
ELECTRICAL SYSTEM	12
WATER SYSTEM	12
TOILET.....	13
HEATING.....	13
COOKING	13
FRIDGE	13
BEDDING	13
SAFETY EQUIPMENT	14
SMOKE DETECTOR/CARBON MONOXIDE ALARM	14
FIRE EXTINGUISHER.....	14
PROPANE DETECTOR/ALARM.....	14
RETURNING THE VEHICLE	15

Dear Vacationers,

Thank you for choosing us for your motorhome rental while spending your vacation in Canada. We hope you will have a great and relaxing time!

Your FRASERWAY & FOUR SEASONS Team



ROADSIDE ASSISTANCE

If you experience any problems with your RV, please call your **Fraserway & Four Seasons OnRoad Support Service**. Our emergency service is available at **1-866-535-6601** and **1-604-636-3057**. Emergency service hours are:

Monday - Friday	4:00	am	-	9:00	pm	PST
Saturday, Sunday, Holiday	6:00	am	-	6:00	pm	PST

Please note that the time zone for above hours is that of British Columbia and Yukon (Pacific Standard Time or UTC-8, daylight saving time: UTC-7).

Outside these times, your call will be answered by an external call center and assigned to us. We will then contact you as soon as possible during normal business hours.

Fraserway & Four Seasons-OnRoad-Service
1-866-535-6601 and 1-604-636-3057
is available from April 1st until October 31st, 2024!

Necessary information for calling Fraserway & Four Seasons-On Road Service
1-866-535-6601 and 1-604-636-3057

When calling our OnRoad Support Service, please have the following information ready in order for our support team to assist you as efficiently as possible:

Your RENTAL AGREEMENT NUMBER

(This RENTAL AGREEMENT NUMBER can be found in the upper left corner of your rental agreement)

OR

Your UNIT NUMBER

(This UNIT NUMBER can be found on your key tag)

Your exact current location

(Province, city, street/intersection, campsite, pitch number)

AND

Your further travel plans.

(Province, cities for the next 2 to 3 days)

Please describe the problem as detailed as possible!

IMPORTANT: Without the information above we are not able to identify you and might not be able to contact you if you have to leave a message.

Thank you for your assistance!

IN CASE OF AN ACCIDENT

Find out if anybody has been injured whom you have to take care of first.

If there are injuries or larger material damages, call the police and, if necessary, an ambulance. The emergency number to call is 911.

Inform your Fraserway/Four Seasons-OnRoad-Service of the accident.

Exchange all necessary information with the persons involved in the accident.

Record the following information at the scene of the accident, using the accident report form in your Fraserway manual.

Your notes should include names, addresses, phone numbers, insurance names and policy numbers, driver's license numbers and vehicle information incl. license plate numbers. If the driver's name is different from the name of the insured, find out which relationship the persons have, and note the names and addresses of both persons. Also note the description of the vehicles involved incl. model year, brand, type and color. Note the street names, intersections and street numbers. Also helpful are ID numbers of any present police officers and their incident number.

In any case, take pictures of the scene of the accident and of all vehicles involved. If possible, pictures should include all damages to all vehicles involved. If there are any uninvolved witnesses, note their names. This may be very important if the accident ends up in a legal dispute with another party to the accident.

	Phone No.	Monday Friday	Saturday	Sunday/Holiday
Fraserway / Four Seasons OnRoad Support Service	1-866-535-6601* and 1-604-636-3057 (times as shown above!)			
Police/Ambulance	911	24/7	24/7	24/7
Ford Roadside Assistance	<u>Within Canada:</u> 1-800-665-2006* <u>Within the U.S.:</u> 1-800-241-3673*	24/7	24/7	24/7
Kal Tire 24-Hour Roadside Assistance	<u>Within Canada:</u> 1-888-525-8473* <u>Within the U.S.:</u> Not available in the U.S.	24/7	24/7	24/7

Kal Tire is not available in the provinces of Newfoundland, Labrador, New Brunswick, Prince Edward Island and Nova Scotia. Please note that with * marked phone numbers are toll-free from a Canadian land line. If you call from your cell phone, your phone provider may charge a fee, which we have no influence on.

CANADIAN TRAFFIC RULES AND ROAD SIGNS

TRAFFIC RULES

ALCOHOL AND DRUGS

Permitted blood alcohol levels are mandated by the provinces and territories. Please do not drive under the influence of alcohol and/or drugs!

TRAFFIC LIGHTS



Traffic lights are suspended across the intersection. Left turn arrows indicate that you can safely turn left while the oncoming traffic is still stopped at a red light.

After you have come to a complete stop and made sure the intersection is clear of all vehicles, cyclists and pedestrians, you may turn right despite a red light in the U.S. and Canada except for the island of Montreal in Québec. Exceptions are often limited to certain times and clearly posted as below.



Example on the left: Turning right is prohibited on red.

Example on the right: Turning right is prohibited from Monday to Friday, 7AM - 9AM and 4PM - 6PM (no matter whether there are traffic lights or not).



SEAT BELT

Canadian and U.S. laws require driver and all passengers to be seated with the seat belt fastened when the vehicle is in motion.

SPEED LIMITS

The Speed limit in most urban areas is 50 km/h, and on highways either 80 or 100 km/h, unless otherwise posted.

PEDESTRIANS

Canadian drivers are usually very polite and considerate. Pedestrians have the right of way.

DRIVER'S LICENSES

We require your national license for RV rentals. Foreign licenses are generally accepted in Canada. However, we recommend carrying an international driver's license in addition, unless your original license is issued in English or French.

GPS SYSTEMS AND HEIGHT RESTRICTIONS

Your RV's external dimensions and gross vehicle weight (GVW) are shown on a windshield sticker and in the manual. GPS systems do not provide any information on height restrictions on your planned route. Always check restriction signs for tunnels, overpasses, gas stations, roof constructions, ferries, etc.! Drive-thrus at fast food outlets or entry ways to hotels/motels are generally too low for RV's!

As a general rule: the minimum clearance must be 3.70 m or 12 ft. for all of our vehicles.

HOV LANE (HIGH OCCUPANCY VEHICLE LANE)

HOV lanes are for vehicles with two or more people inside. These lanes may only be used by vehicles that carry the minimum required number of people. The HOV lane symbol is a diamond, which is indicated on many HOV signs and above all, on HOV lanes. Example of signs:



Left: HOV lane for buses and vehicles with at least 3 people starts here.

Right: From 5AM to 11PM, this lane is an HOV lane for buses and vehicles with at least 3 people only. During the time from 11PM to 5AM, this lane may also be used by vehicles with fewer people.



Fraserway RV's allowed on HOV lanes:	Fraserway RV's NOT allowed on HOV lanes:
<ul style="list-style-type: none"> • Van Conversion • Truck • C-Small 	<ul style="list-style-type: none"> • C-Medium, C-Large, C-XLarge • A-Class

PARKING

Regulations vary from province to province. As a general rule, parking is only permitted in the driving direction of the traffic lane. Parking is not permitted within 6 meters either side of:

- Pedestrian crossings
- Curves or corners
- Entrance/Exit of hotels, theatres, public meeting places, schools, fire departments, playgrounds
- Stop signs
- Fire hydrants
- Traffic control signals

CAUTION:	A yellow curb side generally marks a no-parking zone. If your vehicle uses more payable parking spots, you have to pay for the number of spots used!
-----------------	--

EMERGENCY VEHICLES

If a police car, fire truck or ambulance with flashing lights and/or sirens is approaches (from ahead or the rear), pull over to the right and wait until the vehicles have passed.

If you are stopped by a police car, pull over to the right, remain seated, open the window and wait for the officer to approach. Keep your hands visible on the steering wheel and follow the orders of the officer.

STOP SIGNS



You must always come to a complete stop at the stop line. The driver that arrived at a 4-way stop first has the right-of-way. When two cars arrive at the same time, yield to the car on your right-hand side. The same rule applies if traffic lights are not working. Canadians are usually disciplined and courteous.

Only one car at a time can cross the intersection.

TOLL BRIDGES

If you are aware that you have crossed a toll bridge on your journey, please inform us upon return of the RV to avoid additional administrative charges. Fraserway RV will be billed directly by the company responsible for collecting the toll fee.



Some crossings will require direct payment on the spot. Please use the truck lane to avoid any height restriction issues.

ACCIDENTS

Most accidents happen while parking the RV. This damage can be easily avoided if a passenger gets out of the vehicle to help the driver maneuvering by giving directions.

Never settle or admit any wrong-doing at the accident scene! If needed call the Police. If possible make notes, take pictures and exchange information with the other party.

Always call our OnRoad-Service and fill in the accident report, which you will find in the "Emergency" section of the instruction manual. The police will not attend to minor accidents without personal injury.

SCHOOL BUSES



Canadian school buses are yellow. They signal to stop all traffic (no passing!) using flashing red lights and/or a swing-out stop sign. It is against the law to pass a stopped school bus. All traffic must come to a halt to ensure children can get on and off the bus safely. Once the signals have been turned off and/or the stop sign has been pulled, the traffic can move again in both directions. Failure to obey this traffic rule is a serious offence. Only if the road is separated by a median, can the oncoming traffic slowly proceed without stopping.

ROAD SIGNS



One way street



Pedestrians are not allowed to cross the street here.



Crossing the road is only permitted at crosswalks.



Do not enter.



Vehicles parked in this zone without a permit will be towed.



Road is closed. The arrow points in the direction of the detour.



From this point, do not change lanes until further notice.



Authorized vehicles only (buses, emergency vehicles, etc.).



No parking on either side of the sign. If the arrow points in one direction only, do not park on the side it points to.



No stopping on either side of the sign.



This road or lane is for bicycle use only.



This road or lane is for buses only.



Private property. No parking.



Turn headlights on and remove sunglasses (common at tunnel entrances).



No parking from 8:30AM to 5:30PM. Parking is allowed during the remaining hours.



No parking except on Sundays and on holidays.



No parking. Loading zone.

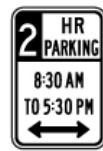

Parking on both sides of sign daily 8:30AM - 5:30PM for 2 hours. Parking disks are not used in Canada.

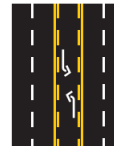

Drivers travelling in opposite directions share the centre lane for left turns.



On multi-lane highways: Sign in combination with exit signs means that a lane ends and becomes the exit lane.



Control signal: Placed over lanes to indicate which ones are open for driving. Here: RED = do not drive in Right lane.



YELLOW: Move into one with a green arrow. If flashin yellow over all lanes: Slow down and proceed with caution.



Green arrow: Drive in this lane.

CABIN

All vehicles are equipped with an automatic transmission, power steering and power brakes. The Ford F-150 V6 EcoBoost engine displacement is 3.5 litres and an output of up to 325 hp.

IGNITION

To start the engine

- Make sure that you have the key inside the unit.
- Step on the brake pedal and
- press the start/ignition button ❶



To switch off the engine

- Press the button ❶ again without the foot on the brake pedal.

AUTOMATIC TRANSMISSION

The gear selector is on the right-hand side of the steering column. The instrument cluster displays the current position. Your right foot must be depressing the brake pedal to shift. The gear selector has the following positions:

P	❶	PARK	to start or turn off the engine.
R	❷	REVERSE	to reverse the vehicle. The rear-view camera is activated automatically.
N	❸	NEUTRAL	select this position for towing only!
D	❹	DRIVE	most efficient position for all normal driving conditions.
M	❺	MANUAL	For manual shifting. Please do not use!



TOW/HAUL

The Tow/Haul function optimizes the shifting performance and reduces the potential for transmission overheating or failure due to excessive shifting when driving in mountainous areas. This provides extra power when going uphill and braking assistance from the engine when going downhill to reduce the risk of overheating the vehicle's brakes. Select this function by turning the drive mode switch ❶ counter clockwise ❷ until you see TOW/HAUL in the display ❸.

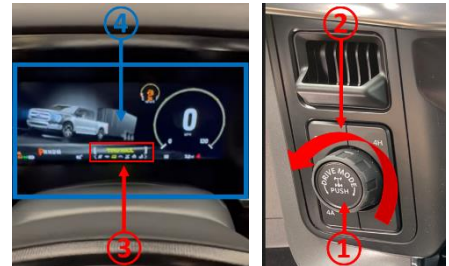

CRUISE CONTROL

The RV is equipped with Cruise Control. The minimum speed required for its use is 50 km/h. We do not recommend using the cruise control on mountain roads because it would cause irregular shifting and accelerating resulting in excess transmission wear and increased fuel consumption.

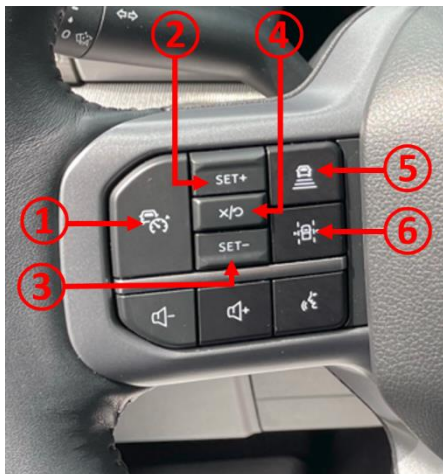

- ❶ Turn cruise control **ON** or **OFF** using the **ON/OFF** button.
- ❷ Accelerate by pressing **SET +** until reaching the desired speed. Release the button and the speed will be maintained. Alternatively, the foot pedal can be used to increase speed, then briefly press the **SET +** button to maintain speed automatically.
- ❸ Speed can be reduced by pressing **SET -**.
- ❹ Press **CANCEL** to pause the cruise control.
- ❺ Press this button to set the automatic distance to vehicles in front of you while using cruise control. It is your responsibility to keep enough distance. We recommend to set the **GAP DISTANCE** to 4 (Far).
- ❻ You can switch **LANE CENTERING** on and off with this button. Nevertheless: **Even if you have LANE CENTERING turned on, you have to keep your hands on the steering wheel all the time!**

PARKING BRAKE

To engage the parking brake, pull the lever ①, located left hand side of the steering wheel. To release the brake, push the lever while having you foot on the brake pedal.



LIGHTS

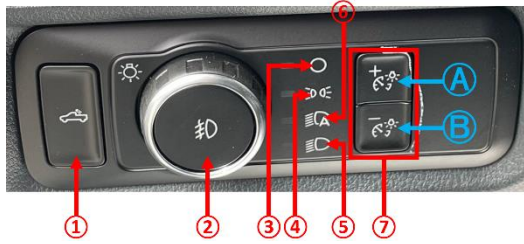

- ① Cargo Lamp
- ② Front Fog Lamps
- ③ Lamps OFF
- ④ Parking Lamps
- ⑤ Headlamps
- ⑥ Automatic Lamps
- ⑦ Instrument Panel Lights
- A Brighter
- B Darker

DRIVE MODES



2H for regular driving.

4A Four-wheel drive auto provides electronically controlled four-wheel drive power to both the front and rear wheels, as required, for increased traction in varying on-road conditions.

4L Four-wheel drive low provides electronically or mechanically locked four-wheel drive power to both the front and rear wheels mainly for use on low traction.

4H Four-wheel drive high provides electronically or mechanically locked four-wheel drive power to both the front and rear wheels for use in off-road or winter conditions such as deep snow, sand or mud. This mode is not for use on dry pavement. Do not exceed 50 km/h on 4H setting!

ATTENTION:

We highly recommend to use the **2H** drive mode! Please note that improper use of the 4x4 may not be noticed until the vehicle is inspected after check-in. We therefore reserve the right to inform and charge renters after the vehicle is returned.

INSTRUMENT CLUSTER OVERVIEW

Our trucks are equipped with an information display for drivers to monitor vehicle systems, receive alerts, and program and configure certain vehicle features. When the engine is turned on you will see the INSTRUMENT CLUSTER similar to the picture on the right.



- ① Tachometer (indicates engine speed)
- ② Engine coolant temperature
- ③ Oil pressure
- ④ Configurable, for example oil pressure
- ⑤ Fuel gauge
- ⑥ Speedometer (indicates vehicle speed)
- ⑦ Current mode (P, R, N, D or M)
- ⑧ Temperature (here in Fahrenheit)
- ⑨ Current played music
- ⑩ Info Center (see description below)
- ⑪ Compass
- ⑫ Odometer
- ⑬ Vehicle is ready for driving

INFO CENTER ⑩

This part of the steering wheel allows you to get a lot of information about your truck. By pressing the **MENU** ④ button, you will get into the directory ⑥ with the different **MENU ITEMS**. You can move **UP** ③ and **DOWN** ⑤ in the directory. To chose an item, please press **OK** ②. To go back to the directory please press the **BACK** ① button.

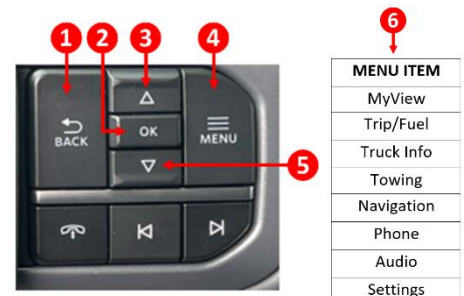

VEHICLE CARE AND MAINTENANCE

GASOLINE



The engine requires **REGULAR UNLEADED GAS** (Octane 87). Please use big-brand stations for refuelling, such as Esso, Shell, Chevron, Husky, Petro Canada, Irving, etc. The fuel available at independent stations is often of a lower quality which can cause problems by clogging fuel pumps, etc., resulting in trip disruption and expensive repairs.

ENGINE OIL

The engine oil level must be checked every 1500 kms. The engine should be cold when its oil level is checked. **ONLY SAE 5W-30 FULL SYNTHETIC OIL** can be used for topping up. Please keep receipts for oil that is purchased for reimbursement upon return of the vehicle. Thank you for your care and attention.

CAUTION:	The renter is liable for ALL damage resulting from use of improper fuel, oil, or other engine fluids. If you have any questions, doubts or concerns, please call our OnRoad-Service.
-----------------	--

OIL CHANGE INDICATOR LIGHT ILLUMINATES

We change the oil of our vehicles every 12,000 kms according to the manufacturer's recommendation. The oil change light may illuminate earlier as it is programmed to a different schedule. The odometer reading of the last oil change is indicated on a sticker on the windshield. If the window sticker indicates that an oil change is due, please call our OnRoad-Service for direction to an authorized auto repair shop. Please keep receipts for all oil purchases and present them for reimbursement upon return of the vehicle.

TIRES

TIRE CHECK

Please check the tire pressures regularly. The tires should be cold when the pressure is checked!

Recommended tire pressure (cold): The recommended tire pressure is indicated on a sticker inside the driver-side door frame. The wheel nuts should be visually checked every time you leave a campground.

CHANGING THE TIRES

Tires should only be changed by authorized personnel of the FORD Road-Side Assistance program or of KalTire 24-Hour Service. Please contact our OnRoad-Service whenever a tire change is required. These numbers are listed in the "Emergency" appendix. Please only attempt to change a wheel if there is no way to contact us for assistance. Changing a wheel is at your own risk. The wheel nuts of the changed wheel must be checked after 100 kms or sooner and retightened if necessary. Failure to do so could cause serious accidents.

WARNING:	The renter is liable for damage resulting from improper tire change or non-preformed checks.
-----------------	--

STORAGE LOCATION FOR TIRE CHANGE TOOLS

The jack and tools are located under the passenger-side rear seat of the truck. They are accessed by pulling the side lever on the back rest and folding the back rest forward.

VEHICLE SPECIFICATIONS

Motorhome class – Truck model	Truck Camper - FORD F-150 3.5 Litres V6 Gasoline
Roof air conditioner	No
Microwave	No
Convection oven	No
Oven	No
3-point-seat belts at dinette	No! The camper is not approved for passenger transport.
Bathroom vent	No
TV	No
DVD player	No
Rear dual tires	No
Propane-driven generator	No
Fuel-driven generator (gasoline)	No
Side slide-out	No
Rear slide-out	No
Sleeps	2
Seat belts	5
Fuel type	Gasoline
Bumpers	Steel
Locking lug nuts	Not available
Number of axles	2
Spare tire	Yes, stored in the rear under the chassis.
Tire size and pressure	Please see on a sticker inside the driver-side door frame.
Fire extinguisher	The fire extinguisher is located next to the entrance door.
Sewer hose	No

Dimensions & weight	Metric system	Imperial system
Height (incl. all superstructures)	305 cm	10'0"
Width	250 cm	8'2"
Length	623 cm	20'5"
Gross vehicle weight (GVW - i.e., weight incl. fuel, propane, wastewater and water tanks, maximum number of persons allowed, and luggage)	5,216 kg	11,500 lbs

Fill capacity (litres and gallons)	Metric system	Imperial system
Freshwater tank	18.9 liters	5 gal.
Grey water tank	N/A	N/A
Black water tank	3.78 liters	1 gal.
Fuel tank	136.27 liters	36 gal.
1 Propane bottle	4.5 KG	10 lbs

Interior specifications	Metric system	Imperial system
Overcab Queen bed	59" x 77"	137 cm x 203 cm
Rear queen bed	N/A	N/A
Dinette bed	35" x 70"	89 cm x 178 cm
Pull-out sofa bed	N/A	N/A
Electrically adjustable bunk bed	N/A	N/A
Interior room height	198.12 cm	78"

EXTERNAL VIEW



1. Fuel tank
2. Sink outlet
3. Storage compartment
4. Propane bottle
5. Awning

6. Solar panel
7. 2nd water tank
8. Porch light
9. Furnace with diesel tank
-  110/120V power connection for electrical hook up

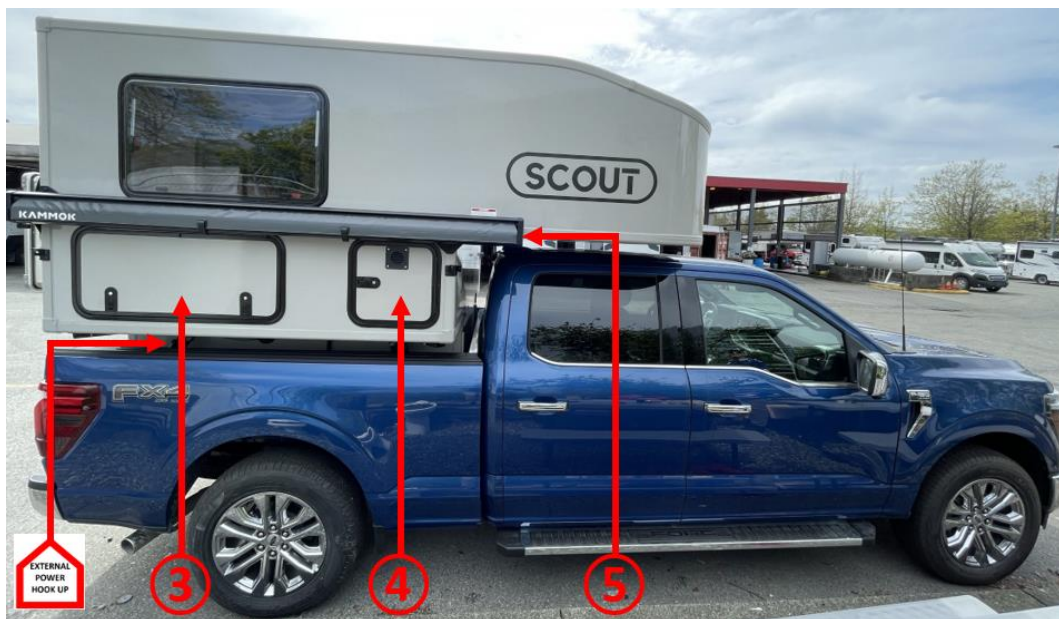

EXTERNAL
POWER
HOOK UP

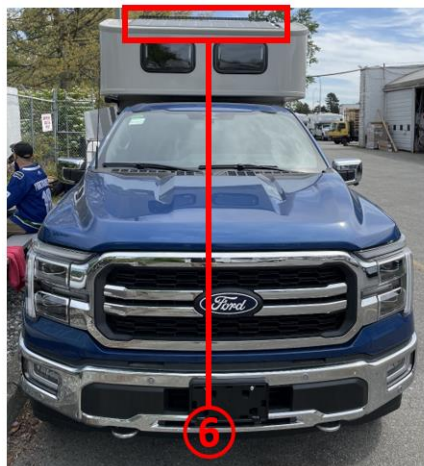

AWNING

Our vehicles are equipped with an awning. The awning is operated manually.

Picture ① shows the retracted awning. Open the safety lever ① and the pressure buttons ②. Then pull the awning all the way out. You can see the extended awning on picture ②. To retract it just simply push it back carefully and secure it with safety lever and pressure buttons again.



IMPORTANT:

- Never use the awning in stormy weather or in strong winds!
- The awning must be retracted overnight or when the RV is unattended.
- Before extending the awning make sure that sufficient space is available.
- Do not reposition the vehicle with the awning extended and always be sure the awning is retracted before

CAUTION: The renter is liable for all damage resulting from improper operation of the awning.

ELECTRICAL SYSTEM

The camper is equipped with a YETI 3000 X power station. The engine battery and the lithium camper battery are both charged by the alternator while you are driving but discharge independently from each other. Furthermore, the battery will be charged when you are plugged in to an external 230W power supply. Another charging option is the solar panel, installed on the roof of the camper.

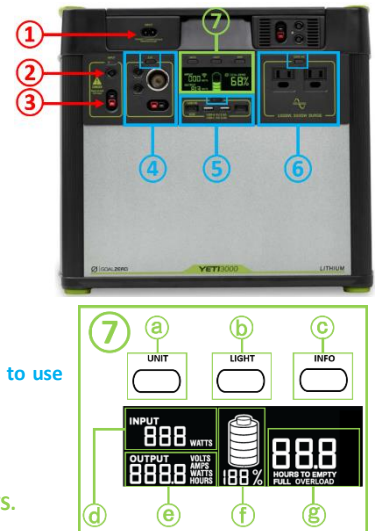

- ① Input for charging
- ② Input for charging
- ③ Input for charging
- ④ 12V Outputs

These inputs will be used for charging the power station by SOLAR, EXTERNAL POWER and/or ALTERNATOR (Engine).
PLEASE DO NOT TOUCH THE CONNECTIONS!

- ⑤ USB A + C Outputs
- ⑥ 110/120V Outputs

Output for 12V appliances. Please press the corresponding button on top to use 12V. **IT HAS TO STAY ON TO OPERATE LIGHTS, THERMOSTAT AND FRIDGE!**
Please press the corresponding button on top to use USB ports.
Please press the corresponding button on top to use 110/120V appliances.

- ⑦ Interactive Buttons and LCD Screen

- a UNIT
- b LIGHT
- c INFO
- d INPUT
- e OUTPUT
- f BATTERY LEVEL
- g TIME

Press to see different unit settings. Make sure it is always showing WATTS.

Press to "wake up" the power system.

Press to see the hours until the system is fully loaded or emptied.

shows the amount of power (watts) going into the Goal Zero Yeti while charging.

shows the amount of power (watts) your current connected devices are using.

shows the current battery level.

shows the hours until the system is fully loaded or the hours to empty with the current usage.

HOOK-UP TO THE POWER GRID (110V)

A power cable is provided with the camper for connecting to the 110V power supply at the campsite. The regular plug is for a 30 AMP connection which is standard at most campgrounds. An adapter is provided for occasions when only 15AMP connection is available. You will find the connection at the passenger side of the unit.



WATER SYSTEM



The SCOUT OLYMPIC comes with a gravity-fed water system with exterior drainage.

To fill the tank, you can unscrew it from the wall (screws ②), open the water tank cap ① and fill it everywhere. As well you can leave the tank at the wall and fill it from the outside by using a long water hose. Use the water tank cap ① as a mechanic pump to get water through the spray head ③. A spare water tank ≈ is attached to the outside of the camper.

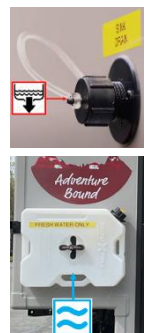

TOILET



The unit is equipped with a portable toilet ① what is stored underneath the fridge ② and right beside the power system ③. To empty the toilet just carry it straight to the dump station.



HEATING



The camper is equipped with an energy efficient diesel heater. The diesel tank ① is mounted at the outside ② of the camper. To turn on the heater press



HEATING MODE ③ on the FURNACE CONTROLLER ③ inside the camper. This will lead you to the THERMOSTAT SCREEN ①. Here you just use your finger to adjust the temperature ④.

COOKING

The camper has a propane driven 2 burner stove top. The propane bottle is stored in the outside compartment on the passenger side.



FRIDGE

The fridge can be powered by AC (110/120V) or DC (12V). We highly recommend to use the 12V power. The 2 compartments can be used as fridge and as freezer as well by choosing the needed temperature. Here are the functions and displays of the control panel:

- | | |
|--|--|
| ① ON/OFF Switch | ⑤ Shows temperature or OFF status for SMALL compartment. |
| ② Sets temperature settings Celsius or Fahrenheit, battery monitor, brightness of display. | ⑥ Status SMALL compartment: LED BLUE = Cooling LED OFF = Not cooling |
| ③ Status LARGE compartment: LED BLUE = Cooling LED OFF = Not cooling | ⑦ Press once to decrease temperature. |
| ④ Shows temperature or OFF status for LARGE compartment. | ⑧ Press once to increase temperature. |



BEDDING

The Scout Olympic comes with a permanent Alcove bed ①. By folding down the table ② and using the cushions ③ as a mattress you can easily build an additional place to sleep.



SAFETY EQUIPMENT

SMOKE DETECTOR/CARBON MONOXIDE ALARM



Each RV is equipped with a combined carbon monoxide alarm/smoke detector. This alarm sounds if an excess carbon monoxide concentration (CO) is measured in the air.

CO is a colour- and odourless gas, which can escape if, for example, there is a malfunction in the burner system of a stove, oven or furnace. Therefore, always make sure that the motorhome is well-ventilated while you are cooking, i.e. open a skylight and/or window.

If the alarm device beeps in intervals without triggering an alarm, it is an indication that the batteries need to be replaced. Replace them immediately to ensure your safety and the device's working condition. Keep all receipts for such expenses so we can reimburse you accordingly.

FIRE EXTINGUISHER

A fire extinguisher is part of the safety equipment in each of our motorhomes. Please see "Vehicle Specifications" for their location within the RV.

PROPANE DETECTOR/ALARM



Each RV is equipped with a propane detector, located near the floor. The alarm goes off whenever an increased propane emission (e.g., from the stove or oven) is detected. Please make sure not to place any objects on the propane detector to avoid false alarms.

Please note that the propane alarm is connected to the coach battery, and if the battery level is too low, the alarm emits a beep every 30 seconds. The coach battery must be recharged to ensure continued safety in the vehicle.

In the event of an alarm:

Please turn off the propane supply on the propane tank, open all windows and doors, and wait outside of the motorhome until the alarm stops. Once the alarm has stopped, please check if the control knobs on the stove and oven are off and if there are any potential propane leaks.

RETURNING THE VEHICLE

TIME

Please return the vehicle READY FOR INSPECTION to your rental station at the latest time stated in the rental agreement to ensure that it can be properly maintained and cleaned for our next customer. Allow sufficient time for packing. The next renter will appreciate it.

TANKS

When returning the vehicle, the black and grey water tanks must be EMPTY and the fuel tank must be FULL.

FINAL CLEANING

Please return the vehicle in good condition and with the interior reasonably clean. We take pride in the condition, investing a lot of time on their maintenance and cleaning.

NO SMOKING

Smoking is not allowed in our vehicles! Violators will be fined according to our "Terms & Conditions".

EXTRA CHARGES

If the vehicle is returned late without prior approval by our rental station, an hourly late fee is charged according to our "Terms & Conditions". We will charge a fee for emptying the wastewater tanks, refuelling the fuel tank and cleaning of the vehicle's interior according to our "Terms & Conditions".

CAUTION:	Renters are fully liable for any traffic violations committed during your rental. Please pay your ticket upon your return at the rental station. For any delays, a processing fee is charged in addition to the actual ticket amount. The fees are listed in our "Terms & Conditions". Thank you for your understanding.
-----------------	--

If you have any questions or concerns, please don't hesitate to contact us. Your rental team would like to thank you and wish you a pleasant time with our Recreation Vehicle.

Your FRASERWAY Team



Disclaimers:

Features, components and appliances depicted in this manual may differ from your rental motorhome depending on the model year. All features, components, appliances, materials, instructions, and guidance depicted and/or described in the manual and documentation are as accurate as possible at the time of creation and initially published but may not be accurate as a result of your rental motorhome having been assembled on a date after the manual or document was produced and initially published. Fraserway RV LP reserves the right to make changes, substitutions and improvements to its products without prior notification. This manual is for demonstrative purposes only. If you are still unsure on how to properly operate any appliance or feature addressed by the manual or documentation, please consult with your local Fraserway RV rental branch directly. This manual is © 2024 Fraserway RV LP, and all related marks, logos, and model names are owned by Adventurer Manufacturing LP and Fraserway RV LP, Inc. or its licensor(s). No portion of this manual may be copied, altered, published, displayed, broadcast, or otherwise used without the express permission of Fraserway RV LP, Inc. All rights reserved.